

High Efficiency eF Series® Light-Duty Power Vent Commercial Gas Water Heater

Features

- **Bradford White ICON System®**— Intelligent gas control that eliminates constant burning pilot, saving gas during standby periods (120 VAC). Proprietary algorithms provide tighter temperature differential and consistent water temperature levels up to 180°F (82°C). LED light indicates pilot function or operation status/service required.
- **Vitraglas® Lining with Microban®**—An exclusively engineered enamel formula that provides superior tank protection from the corrosive effects of water; and with Microban® antimicrobial product protection to help prevent the growth of bacteria, mold and mildew on the surface of the tank lining.
- **Hydrojet® Total Performance System**—Sediment reducing device that also increases first hour rating of hot water while minimizing temperature build-up in tank.

Additional Details

- **Vertical, Dual-pass Heat Exchanger System**—Vertical design eliminates corrosion protection challenges of condensing water heaters that utilize less durable heat exchanger designs.
- **Self-priming Condensate Tee**—No need for trap installation. Internal condensate trap height appropriate for condensate pump use where necessary.
- **Power Vent**—Powerful yet quiet design for greater resistance to outside winds and greater vent lengths for difficult venting situations through the roof or side wall. 10-foot (3m) power cord (120 VAC).
- **Horizontal and Vertical Venting**—With 2" (51mm), 3" (76mm) or 4" (102mm) PVC, ABS, CPVC, PP, or Stainless Steel.
- **Insulation System**—Non-CFC foam insulation covers the sides of the tank, reducing heat loss. This results in less energy consumption, improved efficiencies, and jacket rigidity.
- **Pedestal Base**—Rugged and durable base allows easy transport and positioning while providing corrosion-resistant contact with floor.
- **Water Connections**—3/4" (19mm) NPT factory-installed true dielectric fittings extend water heater life and simplify water line connections.
- **3/4" (19mm) NPT Side Connections**—3/4" (19mm) NPT tapings that allow easy connections for space heating applications (potable water only).
- **Factory installed Heat Traps**—Design incorporates a flexible disk that reduces heat loss in piping and eliminates the potential for noise generation.
- **Two Protective Anode Rods**—Provides added protection against corrosion for long-term, trouble-free service.
- **T&P Relief Valve**—Installed.
- **Low Restrictive Brass Drain Valve**—Durable tamper proof design.
- **NOx Emissions**—Less than 40 ng/J.



Photo is of LC2PV50H763N



3 or 5-Year Limited Tank Warranties / 1-Year Limited Warranty on Component Parts.

For more information on warranty, please visit www.bradfordwhite.com

For products installed in USA, Canada, and Puerto Rico. See complete copy of the warranty included with the heater for limitations.

Microban® antimicrobial product protection helps prevent the growth of bacteria, mold and mildew that may affect the product. The built-in antimicrobial properties do not protect users or others from disease-causing organisms. Microban® is a registered trademark of Microban Products Company.

High Efficiency eF Series® Light-Duty Power Vent Commercial Gas Water Heater



SPECIFICATIONS

Natural Gas and Liquid Propane Gas

These water heaters meet or exceed all or portions of (where applicable) the minimum efficiency requirements of ASHRAE Standard 90.1 (latest edition).

| Model Number | Rated Nominal Volume | | DOE Rated Storage Volume | | | First Hour Rating | | | | | Recovery at 100°F Rise* | Model Number | Rated Nominal Volume | DOE Rated Storage Volume | | | First Hour Rating | | | Recovery at 56°C Rise* |
|--------------|---------------------------|-------------------|--------------------------|--------------------------|--------------------------|------------------------------|----------------------------|--------------------|--------------------------|------------------------------------|-------------------------------------|-----------------------|--------------------------------|--------------------------|------------------------------|----------|-------------------|--------|--------|------------------------|
| | U.S. Gal. | Imp. Gal. | | Gal. | BTU/Hr. Input | | LP BTU/Hr. Input | Gal. | Uniform Energy Factor | U.S. GPH | | | | | Imp. GPH | U.S. GPH | | LP GPH | Liters | |
| LC2PV50H763N | 50 | 42 | 48 | 76,000 | 76,000 | 120 | 0.80 | 82 | 69 | 83 | 69 | LC2PV50H763N | 190 | 182 | 22.0 | 22.0 | 455 | 0.80 | 310 | 314 |
| Model Number | A Floor to Vent Conn. in. | B Jacket Dia. in. | C Vent Size in. | D Floor to T&P Conn. in. | E Floor to Gas Conn. in. | F Floor to Top of Heater in. | G Floor to Water Conn. in. | H Depth in. | J C/L of Water Conn. in. | K Floor to Space Heating Inlet in. | L Floor to Space Heating Outlet in. | M Water Conn. NPT in. | R Space Heating Conn. Size in. | S Gas Conn. Size in. | Approx. Shipping Weight lbs. | | | | | |
| LC2PV50H763N | 67 ^{7/16} | 24 | 2, 3, or 4 | 46 ^{7/8} | 9 ^{3/8} | 46 ^{7/16} | 51 ^{11/16} | 34 ^{7/16} | 8 | 15 ^{5/8} | 46 ^{1/2} | 3/4 | 3/4 | 1/2 | 225 | | | | | |
| Model Number | A Floor to Vent Conn. mm. | B Jacket Dia. mm. | C Vent Size mm. | D Floor to T&P Conn. mm. | E Floor to Gas Conn. mm. | F Floor to Top of Heater mm. | G Floor to Water Conn. mm. | H Depth mm. | J C/L of Water Conn. mm. | K Floor to Space Heating Inlet mm. | L Floor to Space Heating Outlet mm. | M Water Conn. NPT mm. | R Space Heating Conn. Size mm. | S Gas Conn. Size mm. | Approx. Shipping Weight kg. | | | | | |
| LC2PV50H763N | 1713 | 610 | 51, 76, or 102 | 1191 | 238 | 1180 | 1313 | 875 | 203 | 397 | 1181 | 19 | 19 | 13 | 102 | | | | | |

Propane models feature a Titanium Stabilized Stainless Steel propane burner.

For propane (LP) models, change suffix "N" to "X".

Uniform Energy Factor and First Hour Rating is based on the latest AHRI directory listings.

Optional Condensate Neutralizer Kit: p/n A2123601.

| LC2PV50H763N | 2" Vent Pipe | 3" Vent Pipe | 4" Vent Pipe |
|------------------------|----------------------------------|-------------------------------|-------------------------------|
| Max. Equivalent Length | †50 ft. | †120 ft. | †180 ft. |
| Min. Equivalent Length | 7 ft. | 15 ft. | 15 ft. |
| Number of 90° Elbows | 1 45 ft. 2 40 ft. 3 35 ft. | 115 ft. 110 ft. 105 ft. | 175 ft. 170 ft. 165 ft. |
| LC2PV50H763N | 51mm Vent Pipe | 76mm Vent Pipe | 102mm Vent Pipe |
| Max. Equivalent Length | †15.2m | †36.6m | †55.0m |
| Min. Equivalent Length | 2.1m | 4.6m | 4.6m |
| Number of 90° Elbows | 1 13.7m 2 12.2m 3 10.7m | 35.0m 33.6m 32.0m | 53.3m 52.0m 50.3m |

Subtract 5ft. (1.5m) for each additional 90° elbow.

† For high altitude installations, consult the installation instructions.

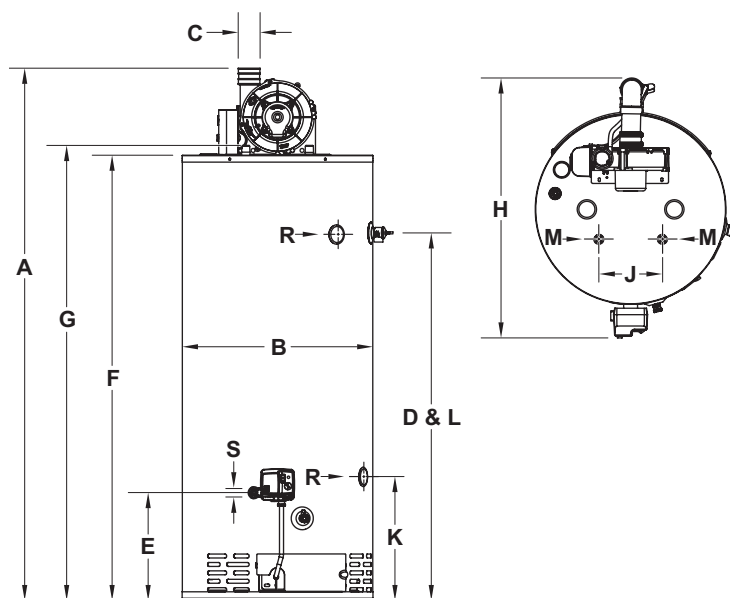

GENERAL:

All gas water heaters are certified at 300 PSI test pressure (2068 kPa) and 150 PSI working pressure (1034 kPa). All water connections are 3/4" NPT (19mm) on 8" (203mm) centers, all gas connections are 1/2" (13mm). All models design certified by CSA International, ANSI standard Z21.10.3 and peak performance rated.

Suitable for Water (Potable) Heating and Space Heating. Toxic chemicals, such as those used for boiler treatment, shall NEVER be introduced into this system. This unit may NEVER be connected to any existing heating system or component(s) previously used with a non-potable water heating appliance.

Dimensions and specifications subject to change without notice in accordance with our policy of continuous product improvement.



Sales: 800-523-2931

24/7 Technical Support: 800-334-3393 • Email TechServ@bradfordwhite.com

Products made by Bradford White are manufactured in America using the finest materials and components from around the world. ©2025, Bradford White Corporation, USA. All rights reserved.

— BRADFORD WHITE IS —



1704-0525