

Light Duty Commercial Atmospheric Vent High Input Gas Water Heater



Photo is of
LG2100H853N

FEATURING:



The Atmospheric Vent High Input Models Feature:

- **Bradford White ICON System™**—Intelligent gas control with proven millivolt powered technology and built-in piezo igniter. A standard, off-the-shelf thermopile converts heat energy from the pilot flame into electrical energy to operate the gas valve and microprocessor. No need for external electricity.
- **Enhanced Performance**—Proprietary algorithms provide enhanced First Hour Rating and tighter temperature differential.
- **Advanced Temperature Control System**—Microprocessor constantly monitors and controls burner operation to maintain consistent and accurate water temperature levels (up to 180°F).
- **Intelligent Diagnostics**—An exclusive green LED light prompts the installer during start-up and provides ten different diagnostic codes to assist in troubleshooting.
- **Pilot On Indication**—Flashing green LED provides positive indication that pilot is on.
- **Separate Immersed Thermowell**—High-strength advanced polymer composite thermowell provides isolation between electric temperature sensor and surrounding water. No need to drain the tank when removing gas valve.
- **Factory-Installed Hydrojet® Total Performance System**—Sediment reducing device that also increases first hour rating of hot water while minimizing temperature build-up in tank.
- **Vitraglas® Lining**—An exclusively engineered enamel formula that provides superior tank protection from the highly corrosive effects of hot water. This formula (Vitraglas®) is fused to the steel surface by firing at a temperature of over 1600°F (871°C).
- **Side Connections**—3/4" (19mm) NPT tapings that allow easy connections for space heating applications (potable water only).
- **Insulation System**—Non-CFC foam covers the sides and top of the tank, reducing heat loss. This results in less energy consumption, improved efficiencies, and jacket rigidity.
- **Pedestal Base** (except LG2100H853N).
- **Water Connections**—Factory-installed true dielectric fittings extend water heater life and simplify water line connections.
- **Hand Hole Cleanout**—Allows inspection of tank interior and facilitates the removal of sediment deposits (LG2100H853N models only).
- **Protective Magnesium Anode Rod.**
- **4" (107mm) "Snap Lock" Draft Diverter.**
- **T&P Relief Valve**—Installed.
- **Low Restrictive Brass Drain Valve**—Durable tamper proof design.
- **Thermostatic Mixing Valve (ASSE Approved)**—Included with LG255H803N only.
- **NOx Emissions**—Less than 40 ng/J.

3 or 5-Year Limited Tank Warranties / 1-Year Limited Warranty on Component Parts.

For more information on warranty, please visit www.bradfordwhite.com

For products installed in USA, Canada, and Puerto Rico. Some states do not allow limitations on warranties. See complete copy of the warranty included with the heater.

MANUFACTURED UNDER ONE OR MORE OF THE FOLLOWING U.S. PATENTS: 5,682,666; 7,634,976; 5,660,165; 5,954,492; 6,056,542; 6,935,280; 5,372,185; 5,485,879; 5,574,822; 7,971,560; 7,992,526; 6,684,821; 7,334,419; 7,866,168; 7,270,087; 7,007,748; 5,596,952; 6,142,216; 7,699,026; 5,341,770; 7,337,517; 7,665,211; 7,665,210; 7,063,132; 7,063,133; 7,559,293; 7,900,589; 5,943,984; 8,082,888; 5,988,117; 7,621,238; 7,650,859; 5,761,379; 7,409,925; 5,277,171; 8,146,772; 7,458,341; 2,262,174. OTHER U.S. AND FOREIGN PATENT APPLICATIONS PENDING. CURRENT CANADIAN PATENTS: 2,314,845; 2,504,824; 2,108,186; 2,143,031; 2,409,271; 2,548,958; 2,112,515; 2,476,685; 2,239,007; 2,092,105; 2,107,012. Vitraglas®, Hydrojet® and ScreenLok® are registered trademarks of Bradford White® Corporation.

Light Duty Commercial Atmospheric Vent High Input Gas Water Heater

Atmospheric Vent Models

NATURAL GAS AND LIQUID PROPANE GAS

Meet or exceed ASHRAE 90.1b (current standard) C.E.C. Listed

Model Number	Nominal Gal. Capacity		DOE Rated Storage Volume (Gal.)	BTU/Hr. Input		First Hour Rating (Gal.)	Uniform Energy Factor	Recovery at 100°F Rise*				Model Number	Nominal Liter Capacity	DOE Rated Storage Volume (Liters)	kW Input	LP kW Input	First Hour Rating (Liters)	Uniform Energy Factor	Recovery at 56°C Rise*	
	U.S. Gal.	Imp. Gal.						U.S. GPH	Imp. GPH	U.S. GPH	LP Imp. GPH								Liters/Hour	LP Liters/Hour
LG250H653N	48	40	46	65,000	61,000	106	0.63	63	53	59	49	LG250H653N	182	174	19.0	17.9	401	0.63	238	223
LG255H803N	55	46	55	78,000	76,000	117	0.61	78	65	76	63	LG255H803N	208	208	22.9	22.3	443	0.61	295	287
LG275H763N	75	63	72	76,000	76,000	135	0.59	74	62	74	62	LG275H763N	284	273	22.3	22.3	512	0.59	280	280
LG2100H853N	100	83	95	85,000	88,000	157	0.57	82	69	85	71	LG2100H853N	379	360	24.9	25.7	595	0.57	310	322

Model Number	A Floor to Flue Conn. in.	B Jacket Dia. in.	C Vent Size in.	D Floor to T&P Conn. in.	E Floor to Gas Conn. in.	F Floor to Top of Heater in.	G Floor to Water Conn. in.	H Depth in.	J C/L of Water Conn. in.	K Floor to Space Heating Inlet in.	L Floor to Space Heating Outlet in.	M Water Conn. NPT in.	R Space Heating Conn. Size in.	S Gas Conn. Size in.	Approx. Shipping Weight lbs.
LG250H653N	60 1/2	22	4	49 13/16	13	56 5/8	58 7/8	25 1/2	11	13 1/2	49 15/16	3/4	3/4	1/2	193
LG255H803N	58 1/2	24	4	48 1/8	13 1/8	54 3/4	56 1/2	27 1/4	8	13 1/2	48 1/8	3/4	3/4	1/2	207
LG275H763N	62 5/8	26	4	51 7/8	15	59 5/8	60 1/16	29 1/4	11	16 5/8	51 7/8	1	1	1/2	240
LG2100H853N	70 1/16	28 1/4	4	57 3/8	13	63 3/8	66 5/8	31 13/16	16	17 11/16	50 5/8	1 1/4	1 1/4	1/2	424

Model Number	A Floor to Flue Conn. mm.	B Jacket Dia. mm.	C Vent Size mm.	D Floor to T&P Conn. mm.	E Floor to Gas Conn. mm.	F Floor to Top of Heater mm.	G Floor to Water Conn. mm.	H Depth mm.	J C/L of Water Conn. mm.	K Floor to Space Heating Inlet mm.	L Floor to Space Heating Outlet mm.	M Water Conn. NPT mm.	R Space Heating Conn. Size mm.	S Water Conn. NPT mm.	Approx. Shipping Weight kg.
LG250H653N	1537	559	102	1265	330	1438	1495	648	279	343	1268	19	19	13	88
LG255H803N	1486	607	102	1222	333	1391	1435	692	203	343	1222	19	19	13	94
LG275H763N	1591	660	102	1318	381	1514	1526	700	279	422	1318	25	25	13	109
LG2100H853N	1778	718	102	1457	330	1610	1692	808	406	449	1286	32	32	13	192

Propane models feature a Titanium Stainless Steel propane burner. For Propane (LP) models change suffix "N" to "X".

For 5 year models, change suffix "3" to "5".

* Based on manufacturer's rated recovery efficiency
LG2100H853N model features hand hole cleanout.

Uniform Energy Factor and First Hour Rating is based on the latest AHRI directory listings.

NSF kits available.

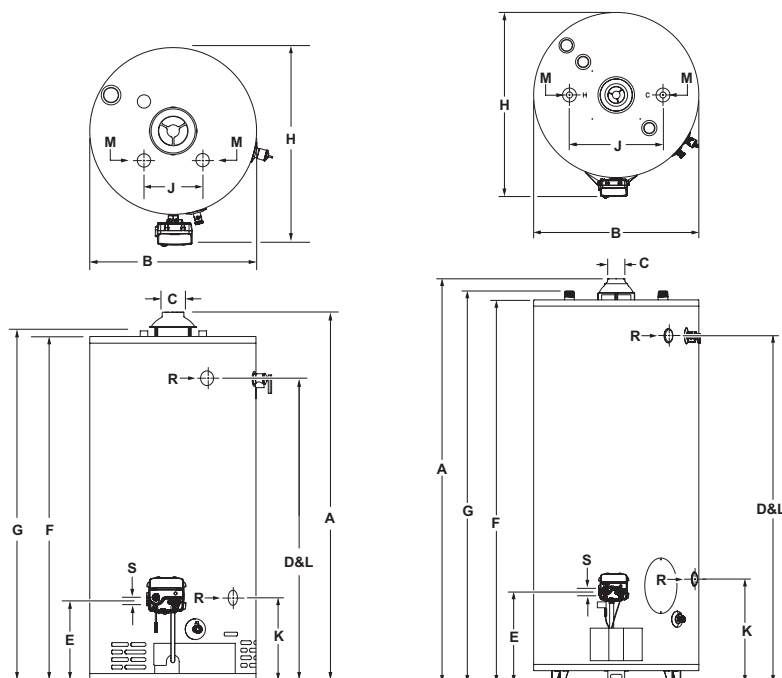

LG250H653N / LG255H803N / LG275H763N

LG2100H853N

General:

Meets NAECA or EPACT Requirements, as applicable.

All gas water heaters are certified at 300 PSI test pressure (2068 kPa) and 150 PSI working pressure (1034 kPa). All gas connections are 1/2" (13mm). All models design-certified by CSA International (formerly AGA/CGA), ANSI standard Z21.10.3 and peak performance rated (RG250H6N = ANSI Z21.10.1).

Dimensions and specifications subject to change without notice in accordance with our policy of continuous product improvement.

Suitable for Water (Potable) Heating and Space Heating. Toxic chemicals, such as those used for boiler treatment, shall NEVER be introduced into this system. This unit may NEVER be connected to any existing heating system or component(s) previously used with a non-potable water heating appliance.

— BRADFORD WHITE IS —



For field service, contact your professional installer or local Bradford White sales representative.

Sales 800-523-2931 ■ Fax 215-641-1612

Technical Support 800-334-3393 ■ Email techserv@bradfordwhite.com

Warranty 800-531-2111 ■ Email warranty@bradfordwhite.com

International: Telephone 1-215-641-9400 ■ Email international@bradfordwhite.com / www.bradfordwhite.com

Built to be the Best™