

Light-Duty Ultra Low NOx Power Vent Gas Water Heater



Photo is of
ULG2PV50H563N

FEATURING:



The TTW® FVIR Eco-Defender Safety System® Models Feature:

- **Ultra Low NOx Burner with Primary and Secondary Air Distribution Devices**—Ensures proper air to gas ratio for reduction of NOx generated by the combustion process.
- **Defender Combustion Chamber**—Incorporates the Advanced ScreenLok® Technology Flame Arrestor and large split-door design to prevent ignition of flammable vapors outside the water heater (excluding ULG2PV75H763N).
- **Flammable Vapor Sensor and Resettable Thermal Switch**—Coordinates with control to prevent burner operation if flammable vapors are detected. The sensor will also prevent operation if there is ongoing flammable vapors burning inside the combustion chamber (excluding ULG2PV75H763N).
- **Maintenance-Free**—No regular cleaning of air inlet openings or flame arrestor is required under normal conditions.
- **Sight Window**—Offers a view into the combustion chamber to observe the operation of the pilot and burner.

All Models Feature:

- **Bradford White ICON System®**—Intelligent gas control with spark to pilot ignition system eliminates the constant burning pilot. This results in savings of pilot gas during standby periods (120 VAC).
 - **Enhanced Performance**—Proprietary algorithms provide enhanced First Hour Rating and tighter temperature differential.
 - **Advanced Temperature Control System**—Microprocessor constantly monitors and controls burner operation to maintain consistent and accurate water temperature levels.
 - **Intelligent Diagnostics**—An exclusive green LED light prompts the installer during start-up and provides ten different diagnostic codes to assist in troubleshooting.
 - **Pilot On Indication**—Flashing green LED provides positive indication that pilot is on.
 - **Separate Immersed Thermowell**—High-strength advanced polymer composite thermowell provides isolation between electric temperature sensor and surrounding water. No need to drain the tank when removing gas valve.
- **Powerful Blower Motor**—Our significantly quiet design has greater resistance to outside winds and the power to vent in many difficult venting situations.
 - Ten Foot (3 meter) Power Cord—Included (120 VAC).
- **Horizontal and Vertical Venting**—PVC, ABS or CPVC (Maximum equivalent vent length on reverse side).
- **Factory-Installed Hydrojet® Total Performance System**—Sediment reducing device that also increases first hour rating of hot water while minimizing temperature build-up in tank.
- **Vitraglas® Lining**—An exclusively engineered enamel formula that provides superior tank protection from the highly corrosive effects of hot water. This formula (Vitraglas®) is fused to the steel surface by firing at a temperature of over 1600°F (871°C).
- **Insulation System**—Non-CFC foam covers the sides and top of the tank, reducing heat loss. This results in less energy consumption, improved efficiencies, and jacket rigidity.
- **Water Connections**—3/4" (19mm) NPT factory-installed true dielectric fittings.
- **Factory-Installed Heat Traps**—Design incorporates a flexible disk that reduces heat loss in piping and eliminates the potential for noise generation.
- **Protective Magnesium Anode Rod.**
- **Pedestal Base.**
- **T&P Relief Valve**—Installed.
- **Low Restrictive Brass Drain Valve**—Durable tamper proof design.
- **All models comply with the latest Ultra Low NOx requirement (10 ng/J NOx limit) except ULG2PV75H763N (14 ng/J NOx limit).**

3 or 5-Year Limited Tank Warranties / 3 or 5-Year Limited Warranty on Component Parts.

For more information on warranty, please visit www.bradfordwhite.com

For products installed in USA, Canada, and Puerto Rico. Some states do not allow limitations on warranties. See complete copy of the warranty included with the heater.

Light-Duty Commercial Ultra Low NOx Power Vent Water Heater

TTW® Ultra Low NOx Models

NATURAL GAS

Meet or exceed ASHRAE 90.1b (current standard) C.E.C. Listed
80% Recovery Efficiency

Model Number	Nominal Gal. Capacity		DOE Rated Storage Volume (Gal.)	Input BTU/Hr.	First Hour Rating (Gal.)	Uniform Energy Factor	Recovery at 100°F Rise*		Model Number	Nominal Liter Capacity	DOE Rated Storage Volume (Liters)	Input kW	First Hour Rating (Liters)	Uniform Energy Factor	Recovery at 56°C Rise*
	U.S. Gal.	Imp. Gal.					U.S. GPH	Imp. GPH							
ULG2PV50H563N	48	40	46	56,000	107	0.68	54	54	ULG2PV50H563N	182	174	16.4	406	0.68	204
ULG2PV75H763N	75	62	72	76,000	121	0.69	74	62	ULG2PV75H763N	284	273	22.3	459	0.69	280

Model Number	A Floor to Vent Conn. in.	B Jacket Dia. in.	C Vent Size in.	D Floor to T&P Conn. in.	E Floor to Gas Conn. in.	F Floor to Top of Heater in.	G Floor to Water Conn. in.	H Depth in.	J C/L of Water Conn. in.	K Floor to Space Heating Inlet in.	L Floor to Space Heating Outlet in.	M Water Conn. NPT in.	N Floor to Air Intake in.	R Space Heating Conn. Size in.	S Gas Conn. Size in.	Approx. Shipping Weight lbs.
ULG2PV50H563N	64 ³ / ₄	22	3 or 4	49 ¹³ / ₁₆	13 ⁷ / ₈	56 ⁵ / ₈	58 ⁷ / ₈	28 ⁵ / ₁₆	11	13 ⁵ / ₁₆	49 ¹³ / ₁₆	3/4	61 ¹ / ₁₆	3/4	1/2	190
ULG2PV75H763N	67 ¹¹ / ₁₆	26	3 or 4	51 ⁷ / ₈	13 ⁷ / ₈	59 ⁹ / ₁₆	61 ¹³ / ₁₆	32 ⁵ / ₁₆	11	16 ⁵ / ₈	51 ⁷ / ₈	3/4	64	3/4	1/2	270

Model Number	A Floor to Vent Conn. mm.	B Jacket Dia. mm.	C Vent Size mm.	D Floor to T&P Conn. mm.	E Floor to Gas Conn. mm.	F Floor to Top of Heater mm.	G Floor to Water Conn. mm.	H Depth mm.	J C/L of Water Conn. mm.	K Floor to Space Heating Inlet mm.	L Floor to Space Heating Outlet mm.	M Water Conn. NPT mm.	N Floor to Air Intake mm.	R Space Heating Conn. Size mm.	S Gas Conn. Size mm.	Approx. Shipping Weight kg.
ULG2PV50H563N	1645	559	76 or 102	1265	352	1438	1495	719	279	338	1265	19	1551	19	13	86
ULG2PV75H763N	1719	660	76 or 102	1318	352	1513	1570	821	279	422	1318	19	1626	19	13	122

Available in Natural Gas only. For 5 year models, change suffix from "3" to "5".

* Based on manufacturer's rated recovery efficiency.

120 VAC Required for Power Venting / 120 VAC, 60Hz., 3.1 Amperes.

Uniform Energy Factor and First Hour Rating is based on the latest AHRI directory listings.

ULG2PV50H563N ULG2PV75H763N	3" Vent Pipe	4" Vent Pipe
Max. Equivalent Length	†50 ft.**	†180 ft.**
Min. Equivalent Length	7 ft.	15 ft.
Number of 90° Elbows	1 45 ft. 2 40 ft. 3 35 ft.	175 ft. 170 ft. 165 ft.

ULG2PV50H563N ULG2PV75H763N	76mm Vent Pipe	102mm Vent Pipe
Max. Equivalent Length	†15.2m**	†55.0m**
Min. Equivalent Length	2.1m	4.6m
Number of 90° Elbows	1 13.7m 2 12.2m 3 10.7m	53.3m 52.0m 50.3m

† For high altitude installations, consult the installation instructions.

** ULG2PV75H763N maximum 3" vent (76mm) is 50 ft. (15m).

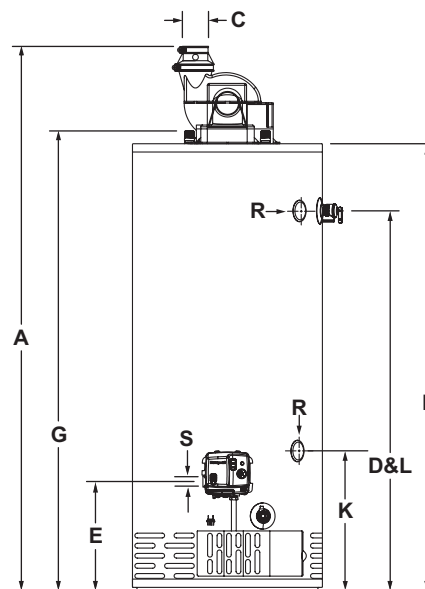
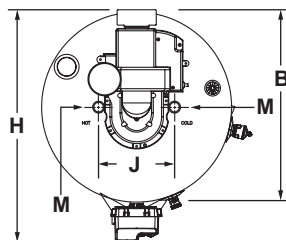

General:

Meets NAECA or EPACT Requirements, as applicable.

All gas water heaters are certified at 300 PSI (2068 kPa) test pressure and 150 PSI (1034 kPa) working pressure. All water connections are 3/4" NPT (19mm) all gas connections are 1/2" (13mm). All models design-certified by CSA International (formerly AGA/CGA), ANSI Z21.10.1 (ANSI Z21.10.3 for 75 gallon) and peak performance rated.

Dimensions and specifications subject to change without notice in accordance with our policy of continuous product improvement.

Suitable for Water (Potable) Heating and Space Heating. Toxic chemicals, such as those used for boiler treatment, shall NEVER be introduced into this system. This unit may NEVER be connected to any existing heating system or component(s) previously used with a non-potable water heating appliance.

— BRADFORD WHITE IS —

**AMERICAN
STRONG**

Sales: 800-523-2931 ■ **Fax** 215-641-1612

24/7 Technical Support: 800-334-3393 ■ **Email** techserv@bradfordwhite.com

Products made by Bradford White are manufactured in the United States using the finest raw materials and components from around the world.

Built to be the Best®