



Residential Energy Saver Gas-Upright Extra Recovery Series (XR)



Features:



Bradford White is ISO registered to the 9001 - standard.

- All residential storage models meet or exceed efficiency requirements of the Department of Energy. ASHRAE Standard 90.1 b (current standard) and the National Appliance Energy Conservation Act of 1987 recent amendment effective January 20, 2004 which supercedes all state and local efficiency requirements.
- **2" Non-CFC foam insulation**—surrounds the tank surface, saving energy by retarding loss of heat. (1" on M1 models)
- **Flue baffle**—designed to maximize the amount of heat absorbed in the lower portion of tank. Minimizes air movement in the heater during standby periods to retard heat loss up the flue.
- **Fully automatic controls**—automatic temperature selection at your fingertips. Built-in energy cut-off switch prevents abnormally high water temperature for extra safety. Built-in gas pressure regulation.
- **Vitraglas® lining**—Bradford White water heater tanks are protected from the corrosive effects of hot water by an exclusive ceramic porcelain-like coating. The Bradford White high silica Vitraglas® lining provides a tough interior surface for our hot water tanks.
- **Protective magnesium anode rod**—provides added protection against corrosion for long trouble-free service.
- **Side tapings**—for space heating.
- **Factory installed Hydrojet® Total Performance System**—cold inlet sediment reducing device. Helps prevent sediment build up in tank. Increases first hour delivery of hot water while minimizing temperature build up at top of tank.
- **Heat Traps**—factory installed, minimizes heat loss through piping.
- **Water Connections**—¾" NPT factory installed true dielectric fittings. Extends water heater life and eases installation (M2XR75 has 1" NPT dielectric waterway fittings).
- **Brass drain valve.**
- **"Snap-Lock" draft diverter.**
- **T&P relief valve included**—all sizes come standard with special tapping on side of tank.
- **Six or ten year limited warranty on steel tank.**
- **Six year limited parts warranty.**
- **Design certified by CSA International (formerly AGA/CMA).**

The Bradford White Defender Safety System™ Models (40 and 48 Gallon Models) Feature:

- **Piezo Igniter**—easy and quick lighting of the pilot burner by push button.
- **Advanced ScreenLok™ Technology Flame Arrestor Design.**
- **Resettable Thermal Switch**—proven and reliable bimetallic switch prevents burner and pilot operation in case of ongoing flammable vapor burn inside of the combustion chamber or restricted air flow.
- **Pedestal Base**—Rugged and durable base allows easy transport and positioning, corrosion resistant contact with floor.
- **Maintenance Free**—No regular cleaning of air inlet openings or flame arrestor is required under normal conditions.
- **Sight Window**—Offers a view into the combustion chamber to observe the operation of the pilot and burner.

MANUFACTURED UNDER ONE OR MORE OF THE FOLLOWING U.S. PATENTS:

5,954,492; 5,761,379; 5,943,984; 5,081,696; 5,988,117; 6,142,216; 5,199,385; 6,684,821; 5,574,822; 5,372,185; 5,485,879; 5,277,171; (B1)5,341,770; 5,660,165; 5,596,952; 5,682,666; 4,904,428; 5,023,031; 5,000,893; 4,669,448; 4,829,983; 4,808,356; 5,115,767; 5,092,519; 5,052,346; 4,416,222; 4,628,184; 4,861,968; 4,672,919; Re. 34,534. OTHER U.S. AND FOREIGN PATENT APPLICATIONS PENDING. CURRENT CANADIAN PATENTS: 1,272,914; 1,280,043; 1,289,832; 2,045,862; 2,112,515; 2,108,186; 2,107,012, 2,092,105.



Photo is of M-2-XR504T6FBN

Residential Deluxe Energy Saver Gas-Upright

The Bradford White Defender Safety
System models meet ANSI Standard
Z21.10.1 – Latest Edition

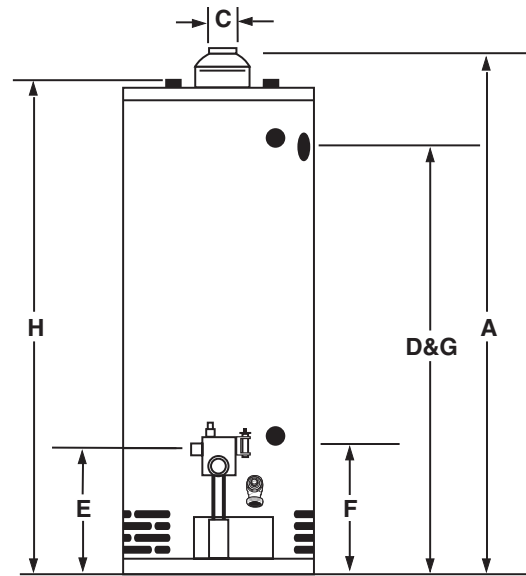
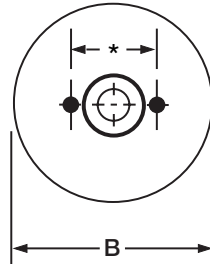

*(Note: M-1-XR403S water connections are on 8" centers, all other models are 11" centers)

XR-Series Energy Saving Models

79% recovery efficiency (M-1-XR65 has 78% recovery efficiency) CEC Listed

										A		B		C		D		E		F		G		H				
			Imp. Gal. Cap.	U.S. Gal.	Liters	Nat. & LP BTU Input	KW Input	Recovery 50°C Rise 90°F Rise		Floor to Flue Conn.		Jacket Diam.		Vent Size		Floor to T&P Conn.		Floor to Gas Conn.		Floor to Space Heating Return		Floor to Space Heating Outlet		Floor to Water Conn.		Approx. Shipping Weight		
								Imp. GPH	U.S. GPH	Liters/ Hour	in.	mm.	in.	mm.	in.	mm.	in.	mm.	in.	mm.	in.	mm.	in.	mm.	in.	mm.	in.	mm.
M-1-XR403S6FBN ^(1,2)			33	40	151	40,000	11.7	36	43	163	50	1270	20	508	3	76	41	1041	13	330	13 3/4	343	41	1041	48 3/4	1232	126	57
M-2-XR50476FBN ^(1,2)			40	48	182	65,000	19.1	57	69	261	59 1/4	1505	22	559	4	102	50	1270	13	330	13 3/4	343	50	1270	57	1448	164	74
M-1-XR65T6BN			54	65	246	65,000	19.1	57	68	257	64 1/4	1638	22	559	4	102	54 1/4	1378	14	356	14 1/4	362	54 1/4	1378	62 1/4	1588	202	92
M-2-XR75S6BN			62	75	284	76,000	22.2	65	78	295	63 3/4	1619	26	660	4	102	53	1346	16	406	17 1/4	451	53	1346	61 1/4	1569	282	127

Natural gas burner assembly meets all current U.S. local codes and emission standards.

All LP Gas heaters equipped with cast iron burner. To order an LP Gas heater, change suffix "BN" to "CX".

Suitable for Water (Potable) Heating and Space Heating

Toxic chemicals, such as those used for boiler treatment, shall NEVER be introduced into this system. This unit may NEVER be connected to any existing heating system or component(s) previously used with a non-potable water heating appliance.

All natural gas models meet SCAQMD requirements.

Meets NAECA requirements.

General

All gas water heaters are certified at 300 PSI (2068 kPa) test pressure and 150 PSI (1034 kPa) working pressure. All water connections are 1/2" (19mm) NPT. The 75 gallon (284 liters) model has 1" (25mm) NPT. All gas connections are 1/2" (13mm). All models design certified by CSA International (formerly AGA/CGA). Recovery on all models based on manufacturers rated recovery efficiency. Change suffix number "6" to "10" for warranty identification.

Dimensions and specifications subject to change without notice in accordance with our policy of continuous product improvement.

6-Year Limited Warranty on Component Parts

BRADFORD WHITE CORPORATION has a 6-year warranty on replaceable parts—thermostat, burner, dip tube, drain valve and piezo igniter. These quality components are manufactured for us by industry leaders and will be replaced in the event of failure during the parts warranty period (exclusive of shipping and re-installation cost).§

6 or 10-Year Limited Tank Warranties

BRADFORD WHITE CORPORATION LIMITED WARRANTY: Protects your investment in a quality glass-lined heater. If the tank leaks for reasons of faulty materials, workmanship, or corrosion within the warranty period, the heater will be replaced with a comparable heater of our manufacture (exclusive of shipping and re-installation cost).§

§ Some states do not allow limitations on warranties. For products installed in USA, Canada and Puerto Rico. See complete copy of the warranty included with the heater.

Vitraglas® and Hydrojet® are registered trademarks of Bradford White® Corporation.

©2005, Bradford White Corporation. All rights reserved.

(LP) LP Propane Gas Inputs

Recovery at 50°C Rise and 90°F Rise

	Imp. U.S. Liters/ Hour	Imp. U.S. Liters/ Hour	Imp. U.S. Liters/ Hour
	GPH	GPH	GPH
M-1-XR403S6FCX 38,000 BTU/H 11.1 kW	33	40	151
M-2-XR504T6FCX 61,000 BTU/H 17.9 kW	54	65	246

BRADFORD WHITE®
CORPORATION
Ambler, PA

For U.S. and Canada field service,
contact your professional installer or
local Bradford White sales representative.

Sales/800-523-2931
Fax/215-641-1670

Technical Support/800-334-3393
Fax/269-795-1089

Warranty/800-531-2111
Fax/269-795-1089

International:
Telephone/215-641-9400
Telefax/215-641-9750

Fax on Demand:
888-538-7833

www.bradfordwhite.com

BRADFORD WHITE-CANADA® INC.
Mississauga, ON

Sales/Technical Support
866-690-0961
905-238-0100

Fax/905-238-0105

www.bradfordwhitecanada.com

Count On Bradford White
For *Everything* Hot Water