



RESIDENTIAL GAS ULTRA LOW NO_x REPLACEMENT PARTS LIST

Direct Vent (UDS) Energy Saver Models



Models Covered:
UDS140S*FRN
(-ONLY,-FLEX,-SOLID)
UDS150S*FRN
(-ONLY,-FLEX,-SOLID)
***Denotes warranty year**

Effective: December, 2024
ECO 8780

NOTE: BOTH MODEL AND SERIAL NUMBERS ARE REQUIRED FOR ORDERING REPLACEMENT PARTS

Dimensions and specifications subject to change without notice.



As required by the state of California Proposition 65.

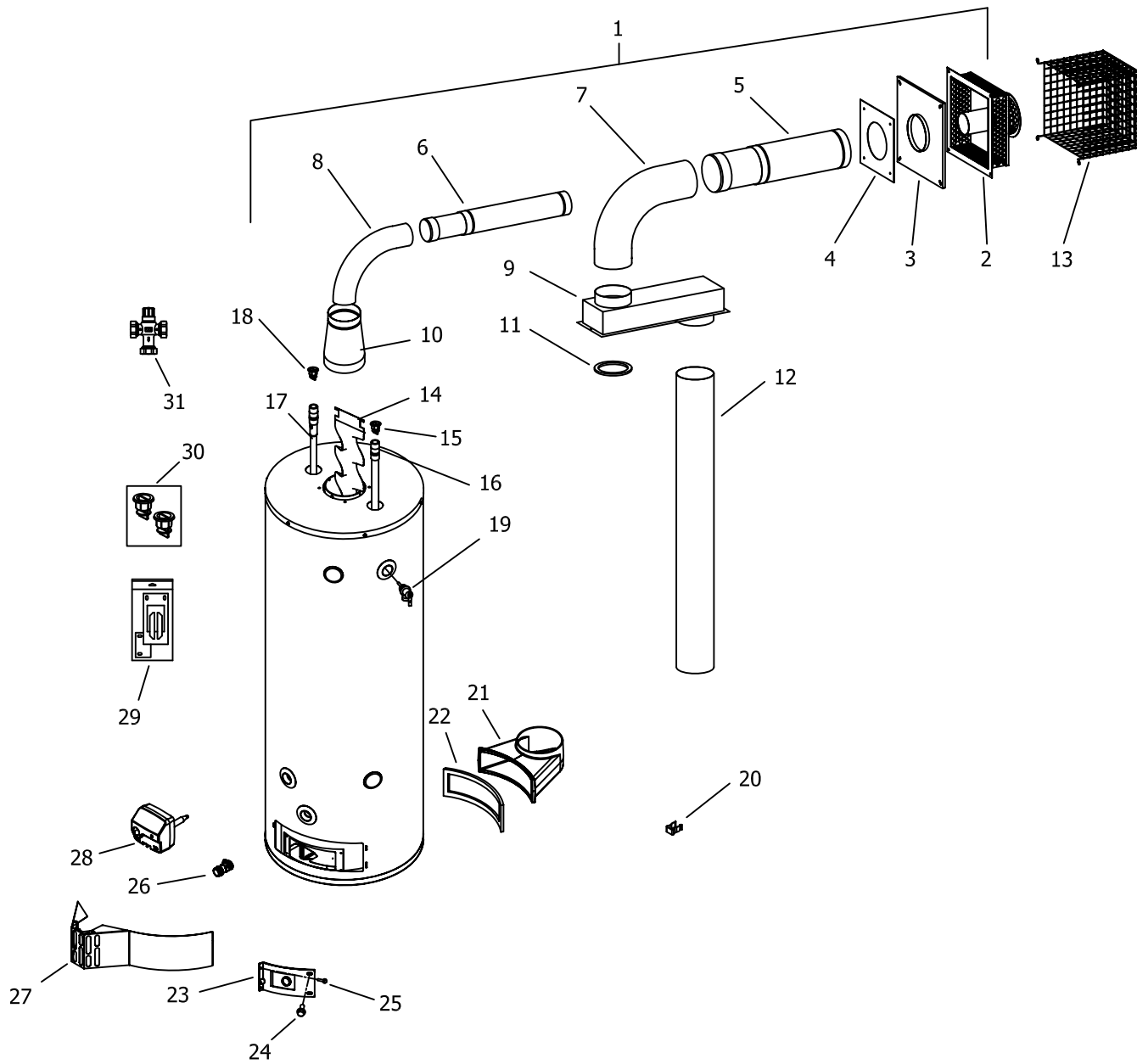

Item	Description	Model	Model
		UDS140S*FRN (-ONLY,-FLEX,-SOLID)	UDS150S*FRN (-ONLY, -FLEX, -SOLID)
1	Vent Package (Solid)	415-47810-00	415-47810-00
	Vent Package (Flexible)	415-47812-00	415-47812-00
2	Direct Vent-Air Intake Terminal (Flexible & Solid)	415-41425-00	415-41425-00
3	Outer Wall Mounting Plate (Flexible & Solid)	415-41431-00	415-41431-00
4	Inner Wall Mounting Plate (Flexible & Solid)	239-41433-00	239-41433-00
5	5" Diameter Telescopic Air Intake Tube (Solid Only)	239-41006-00	239-41006-00
6	3" Diameter Telescopic Vent Tube (Solid Only)	239-41005-00	239-41005-00
7	5" Diameter Elbow (Solid Only)	239-41007-00	239-41007-00
8	3" Diameter Elbow (Solid Only)	239-41008-00	239-41008-00
9	Plenum	239-47663-00	239-47663-00
10	Flue Reducer	239-41009-00	239-41009-00
11	Plenum Gasket	239-41070-01	239-41070-01
12	Air Intake Tube	---	239-50099-02
13	Direct Vent-Air Intake Terminal Guard (Optional)	415-41453-00	415-41453-00
14	Flue Baffle	243-47511-00	243-47412-00
15	Heat Trap Insert (Inlet)	415-45073-00	415-45073-00
16	Cold Water Inlet Dip Tube Polysulfone▲▲	229-51230-03	229-51230-06
17	Hot Water Outlet Anode Magnesium▲	415-47776-05	415-55482-00
	A420 Aluminum▲#	415-55486-00	415-55486-00
18	Heat Trap Insert (Outlet)	415-45167-00	415-45167-00
19	T&P Relief Valve	415-32920-01	415-32920-01
20	Feedline Spring Clip	239-47475-00	239-47475-00
21	Air Intake Boot	239-47771-18	239-47771-18
22	Air Intake Boot Gasket	239-47817-00	239-47817-00
23	Right Side Inner Door	239-48216-18	239-48216-18
24	Screw-#10-12 x 3/4 HWH	239-52581-00	239-52581-00
25	Screw-#8-18 x 3/4 HWH	239-44195-00	239-44195-00
26	Brass Drain Valve	415-42351-02	415-42351-02
27	Outer Door	239-46209-00	239-46209-00
28	Gas Control Direct Replacement Natural Gas	239-49841-01	239-49841-01
	Gas Control Universal Replacement Natural Gas	---	---
29	Inner Door Gasket Kit	239-49597-00	239-49597-00
30	Heat Trap Insert Kit	265-45420-00	265-45420-00
31	ASSE Approved Mixing Valve (Optional)	239-51778-00	239-51778-00

* Applies to all warranties

** Inner door gasket kit recommended

*** Ordering a complete burner assembly may increase delivery time. Please order the specific component required for the quickest delivery.

▲ Order with item 18

▲▲ Order with item 15

A420 Anode may need to be cut to length.

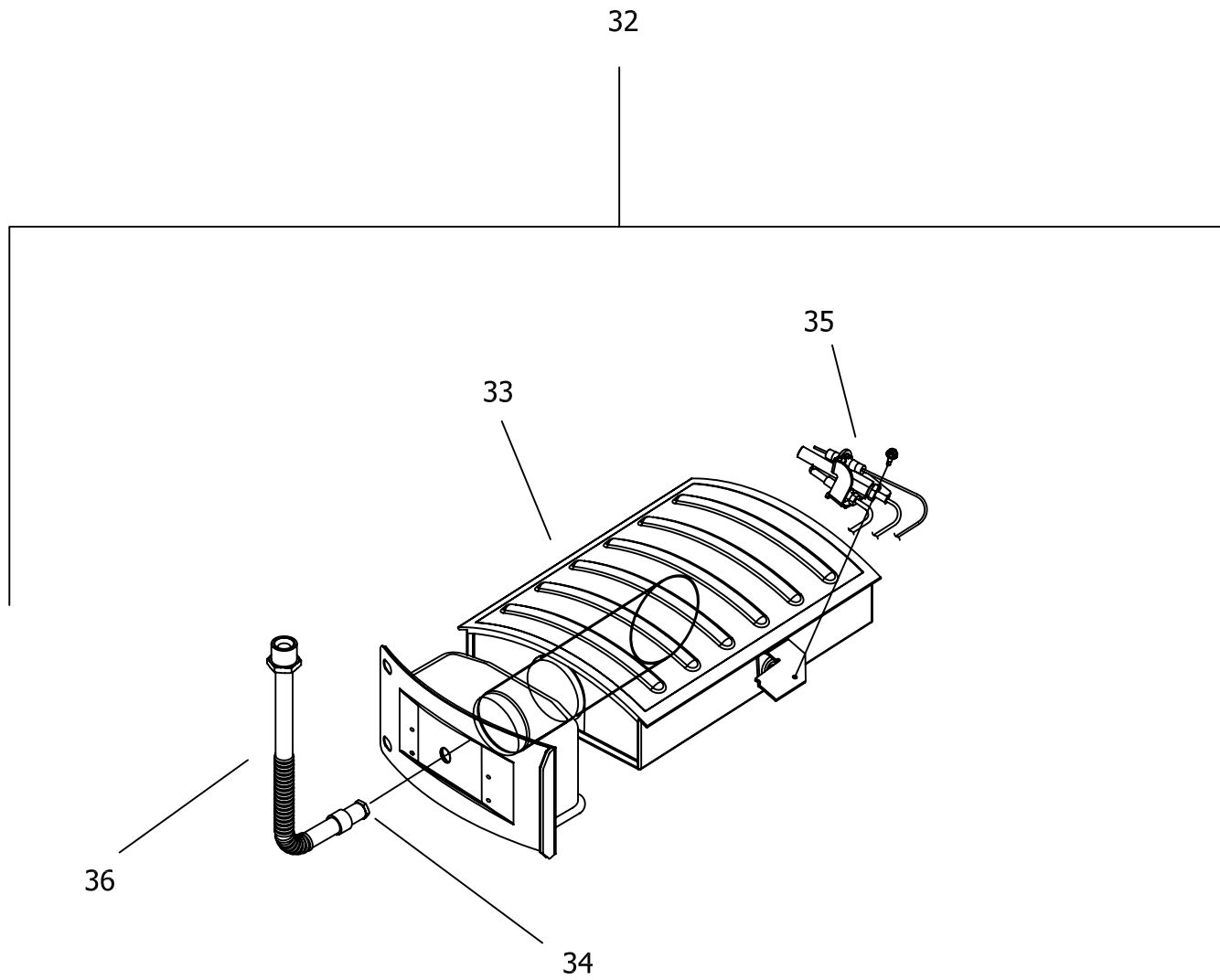

ULTRA LOW NO_x NATURAL GAS (RN) BURNER ASSEMBLY

Item	Description	Model UDS140S*FRN (-ONLY,-FLEX,-SOLID)	Model UDS150S*FRN (-ONLY, -FLEX, -SOLID)
Natural Gas BN Burner Assembly			
32	Nat Gas Burner Assembly Complete***	265-48800-05-37	265-48800-05-37
33	Nat. Gas BN Burner**	228-48691-19	228-48691-19
34	Nat. Gas Main Burner Orifice**	234-18194-37	234-18194-37
	Nat. Gas High Altitude 2001 Ft. to 5000 Ft.**	234-18194-41	234-18194-41
	Nat. Gas High Altitude 5001 Ft. to 8000 Ft.**	234-18194-42	234-18194-42
35	Pilot Assembly**	233-48720-03	233-48720-03
36	Universal Feedline**	233-49006-01	233-49006-01

* Applies to all warranties

** Inner door gasket kit recommended









*** Ordering a complete burner assembly may increase delivery time. Please order the specific component required for the quickest delivery.

▲ Order with item 18

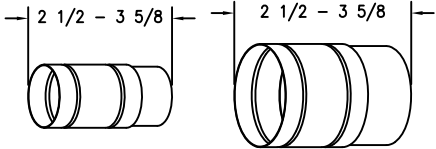
▲▲ Order with item 15

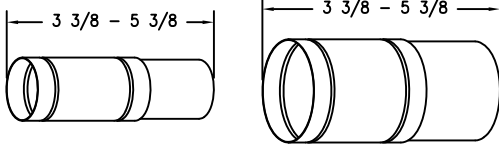
A420 Anode may need to be cut to length.

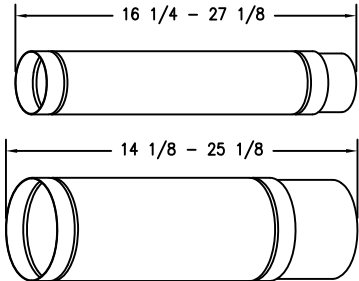
SOLID VENT KITS

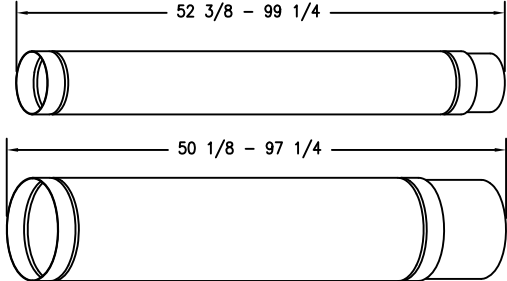
<div style="text-align: center;">  <p>SILICONE SEALANT</p> </div> <div style="text-align: center; margin-top: 20px;">  <p>BAG OF MOUNTING HARDWARE</p> </div> <div style="text-align: center; margin-top: 20px;">  </div> <div style="text-align: center; margin-top: 20px;"> <p>DIRECT VENT-AIR INTAKE KIT A PART NO. 239-41260-00 (OPTIONAL)</p> </div>	<div style="text-align: center;">  <p>SILICONE SEALANT</p> </div> <div style="text-align: center; margin-top: 20px;">  <p>BAG OF MOUNTING HARDWARE</p> </div> <div style="text-align: center; margin-top: 20px;">  </div> <div style="text-align: center; margin-top: 20px;"> <p>DIRECT VENT-AIR INTAKE KIT B PART NO. 239-41331-00 (OPTIONAL)</p> </div>
<div style="text-align: center;">  <p>SILICONE SEALANT</p> </div> <div style="text-align: center; margin-top: 20px;">  <p>BAG OF MOUNTING HARDWARE</p> </div> <div style="text-align: center; margin-top: 20px;">  </div> <div style="text-align: center; margin-top: 20px;"> <p>DIRECT VENT-AIR INTAKE KIT C PART NO. 239-41029-00 (OPTIONAL) ABOVE TUBE LENGTHS SUPPLIED WITH HEATER</p> </div>	<div style="text-align: center;">  <p>SILICONE SEALANT</p> </div> <div style="text-align: center; margin-top: 20px;">  <p>BAG OF MOUNTING HARDWARE</p> </div> <div style="text-align: center; margin-top: 20px;">  </div> <div style="text-align: center; margin-top: 20px;"> <p>DIRECT VENT-AIR INTAKE KIT D PART NO. 239-41424-00 (OPTIONAL)</p> </div>



United States

Sales 1-800-523-2931
Technical Support 1-800-334-3393
Email techsupport@bradfordwhite.com
Warranty 1-800-531-2111
Email warranty@bradfordwhite.com
Service Parts 1-800-538-2020
Email parts@bradfordwhite.com

Canada

Sales 1-866-690-0961 1-905-203-0600
Fax 905-636-0666
Warranty 1-800-531-2111
Email warranty@bradfordwhite.com
Technical Support 1-800-334-3393
Email techsupport@bradfordwhite.com
Service Parts and Orders ca.orders@bradfordwhite.com

For U.S. and Canada field service, contact your professional installer or local Bradford White sales representative.

International

General Contact international@bradfordwhite.com