



RESIDENTIAL INDIRECT HEATER REPLACEMENT PARTS LIST

PowerStor Series™ Single Wall Indirect (SW) Models



Models Covered:

SW-2-(30, 40, 50)-L

SW-2-40R-L

SW-2-50R-L

SW-2-65-L

SW-2-80-L

SW-2-120-L

SW-65C-5

SW-80C-5

SW-120C-5

*Denotes warranty year

Effective: December, 2024

ECO 8780

**NOTE: BOTH MODEL AND SERIAL
NUMBERS ARE REQUIRED FOR
ORDERING REPLACEMENT PARTS**

Dimensions and specifications
subject to change without notice.



As required by the state of California Proposition 65.

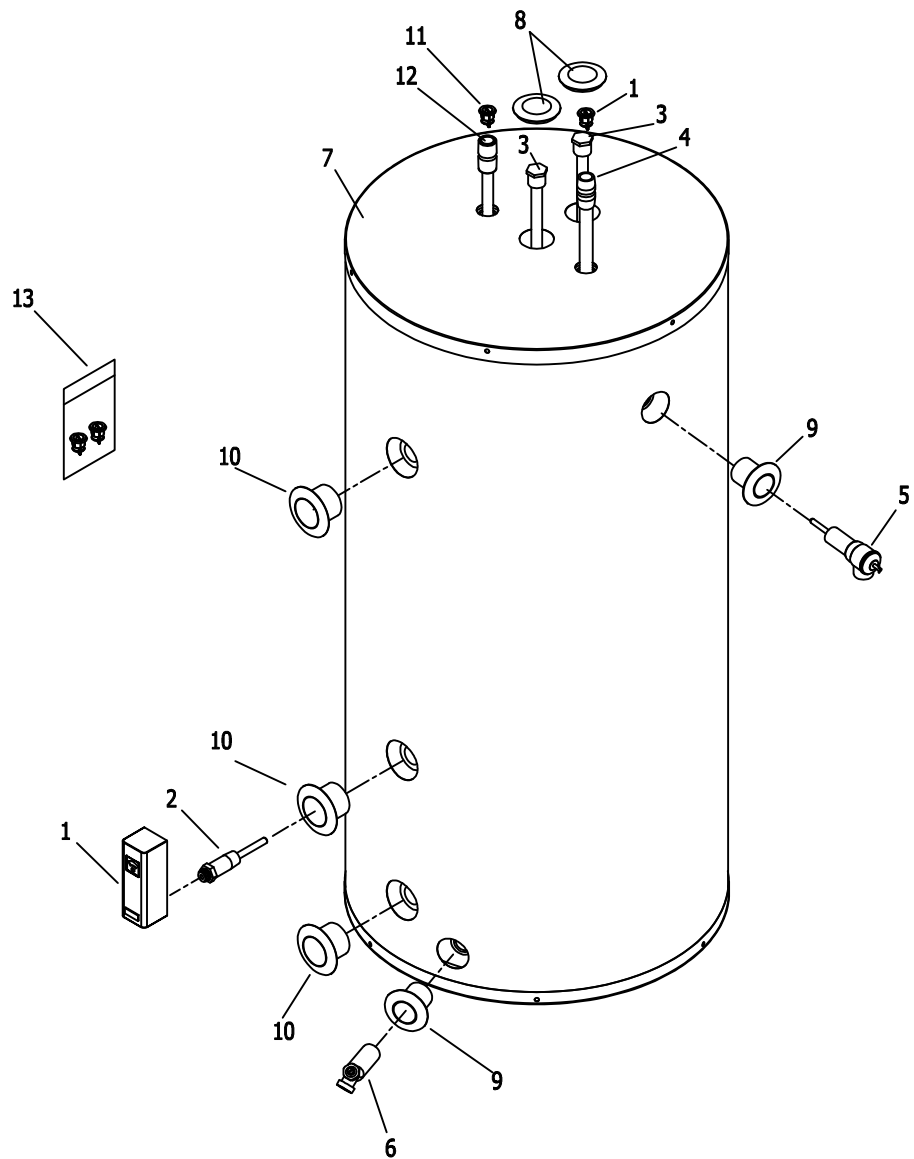

Item Description	Model	Model	Model	Model
	SW230L	SW240RL	SW250RL	SW265L
1 Aquastat	243-44416-00	243-44416-00	243-44416-00	243-44416-00
2 Aquastat Well	233-43315-00	233-43315-00	233-43315-00	233-43315-00
3 Anode-Hex Plug Type (Aluminum)#	415-55485-00	415-55485-00	415-55485-00	415-55485-00
Anode-Hex Plug Type (A420 Aluminum)#	415-55487-00	415-55487-00	415-55487-00	415-55487-00
Hot Water Outlet Anode (Aluminum)	415-55484-00	415-55484-00	415-55484-00	415-55484-00
4 Cold Water Inlet Dip Tube (PEX)*	415-51230-02	415-51230-16	229-51230-06	415-51230-10
6 T&P Relief Valve	415-40594-02	415-40594-02	415-40594-02	415-40594-02
7 Brass Drain Valve	415-42351-02	415-42351-02	415-42351-02	415-42351-02
8 Jacket Head	243-54200-00-22	243-54200-00-22	243-54200-00-22	243-54200-00-22
9 Hole Closure	239-31547-02	239-31547-02	239-31547-02	239-31547-02
10 Escutcheon 2"	239-41337-00	239-41337-00	239-41337-00	239-41337-00
11 Escutcheon Coil Fitting (x2)	239-47978-00	239-47978-00	239-47978-00	239-47978-00
12 Heat Trap Insert (Inlet)	415-51556-00	415-51556-00	415-51556-00	415-51556-00
13 Heat Trap Insert (Outlet) (x2)	415-45167-00	415-45167-00	415-45167-00	415-45167-00
14 Heat Trap Kit (Inlet & Outlet)	265-51572-00	265-51572-00	265-51572-00	265-51572-00

* Nipple extender 229-19100-00 may be required for earlier models, please provide serial number

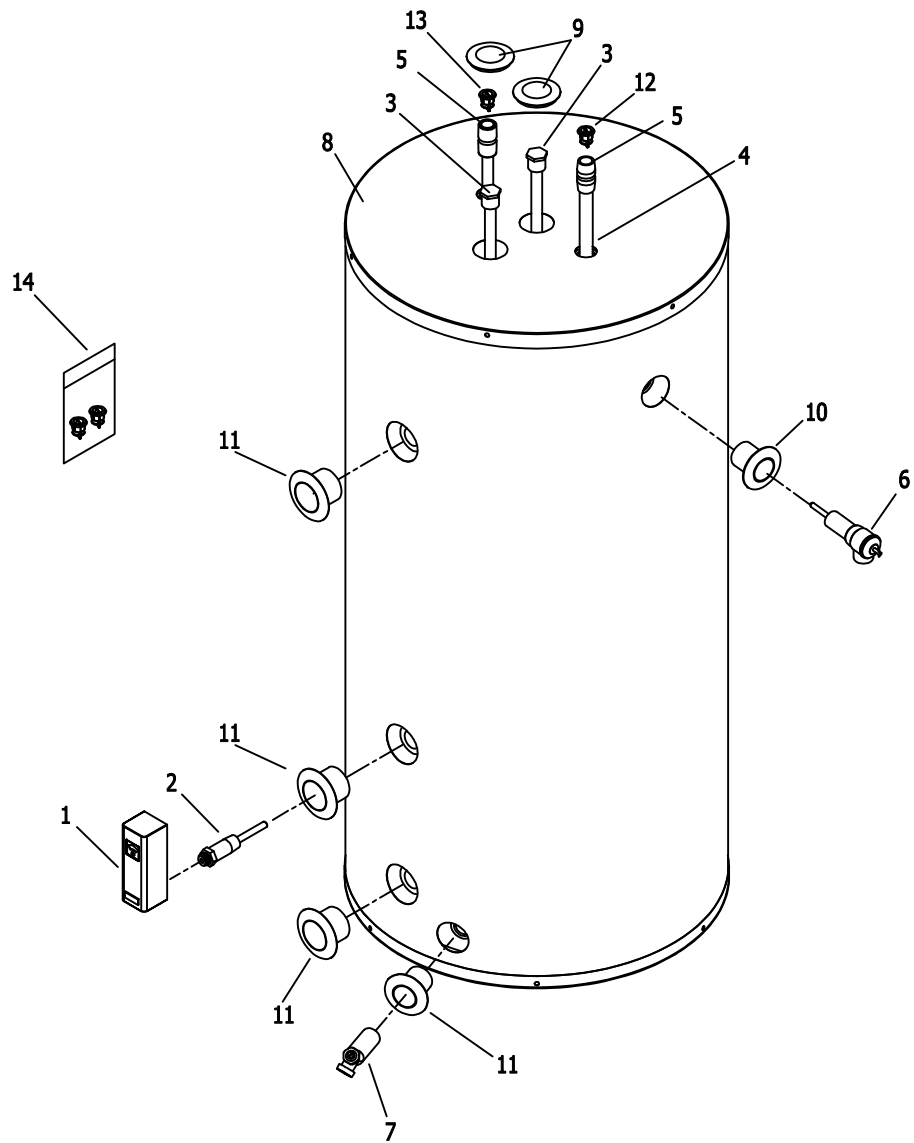

Item	Description	Model SW280L	Model SW2120L
1	Aquastat	243-44416-00	243-44416-00
2	Aquastat Well	233-43315-00	233-43315-00
3	Anode-Hex Plug Type (Aluminum)#	415-55485-00	415-55485-00
	Anode-Hex Plug Type (A420 Aluminum)#	415-55487-00	---
	Hot Water Outlet Anode (Aluminum)	415-55484-00	415-45036-01
4	Cold Water Inlet Dip Tube (PEX)*	415-51230-10	415-43632-04
5	Hot Water Outlet Nipple	---	415-50053-02
6	T&P Relief Valve	415-40594-02	415-40594-03
7	Brass Drain Valve	415-42351-02	415-42351-02
8	Jacket Head	243-53801-00	239-53505-00
9	Hole Closure	239-31547-02	239-31547-02
10	Escutcheon 2"	239-41337-00	239-41337-00
11	Escutcheon Coil Fitting	239-47978-00	239-47978-00
12	Heat Trap Insert (Inlet)	415-51556-00	---
13	Heat Trap Insert (Outlet)	415-45167-00	---
14	Heat Trap Kit (Inlet & Outlet)	265-51572-00	---

* Nipple extender 229-19100-00 may be required for earlier models, please provide serial number

Anode may need to be cut to length

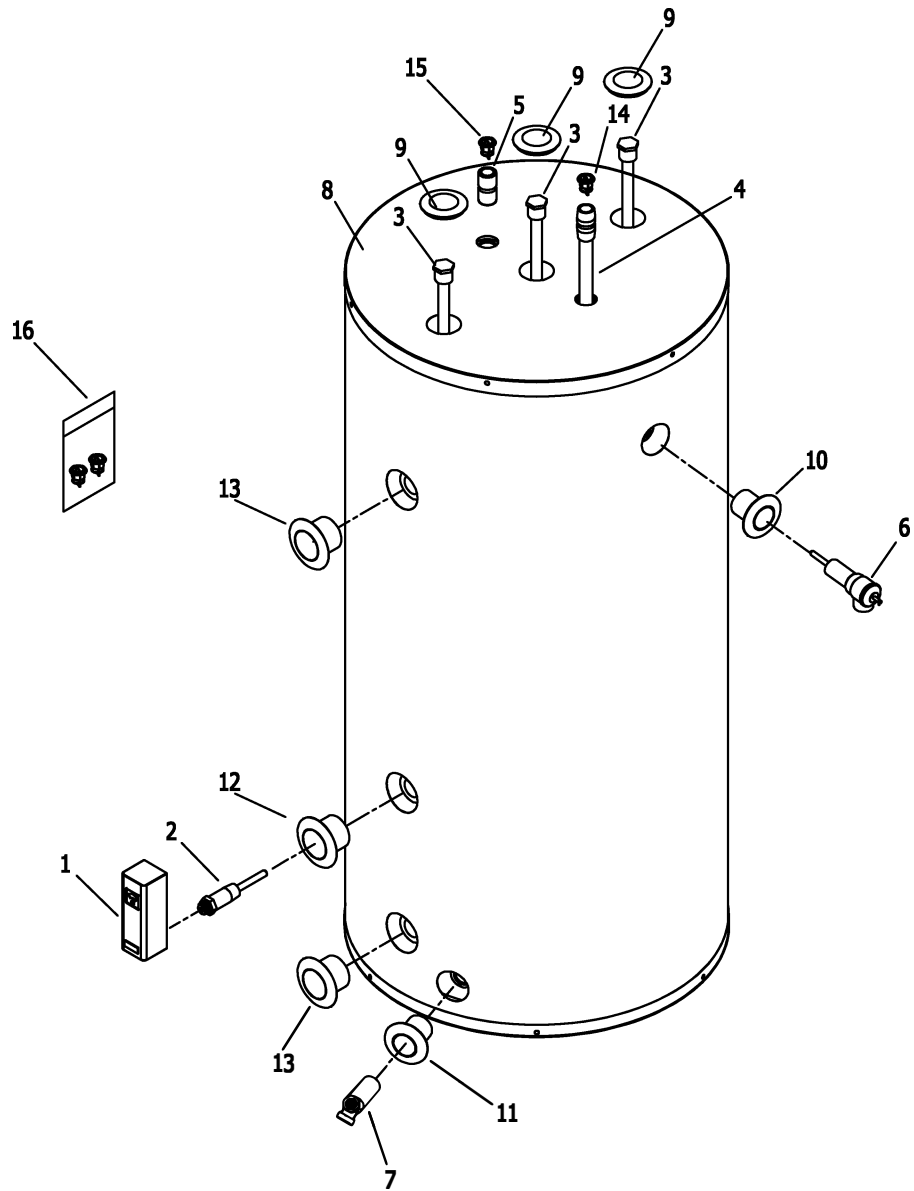

Item Description	Model SW240L	Model SW250L	Model SW65C5	Model SW80C5	Model SW120C5
1 Aquastat	243-44416-00	243-44416-00	243-44416-00	243-44416-00	243-44416-00
2 Aquastat Well	233-43315-00	233-43315-00	233-43315-00	233-43315-00	233-43315-00
3 Anode-Hex Plug Type (Aluminum)#	---	---	415-55485-00	415-55485-00	415-55485-00
Anode-Hex Plug Type (A420 Aluminum)#	415-55487-00	415-55487-00	---	---	---
Hot Water Outlet Anode (Aluminum)	---	---	---	---	---
4 Cold Water Inlet Dip Tube (PEX)	415-51230-02*	415-51230-02*	229-43632-01	229-43632-01	415-43632-04
5 Hot Water Outlet Nipple	---	---	229-50053-04	229-50053-04	415-50053-02
6 T&P Relief Valve	415-40594-02	415-40594-02	415-33630-04	415-33630-04	415-33630-04
7 Brass Drain Valve	415-42351-02	415-42351-02	415-42351-02	415-42351-02	415-42351-02
8 Jacket Head	243-53801-00	---	---	---	243-53505-00
9 Hole Closure	239-31547-02	239-31547-02	239-31547-02	239-31547-02	239-31547-02
10 Escutcheon 2"	239-41337-00	239-41337-00	239-81470-02	239-81470-02	239-81470-02
11 Escutcheon 2"	239-41337-00	239-41337-00	239-41337-00	239-41337-00	239-41337-00
12 Escutcheon 2"	239-41337-00	239-41337-00	239-41414-00	239-41414-00	239-41414-00
13 Escutcheon Coil Fitting	239-47978-00	239-47978-00	239-47978-00	239-47978-00	239-47978-00
14 Heat Trap Insert (Inlet)	415-51556-00	415-51556-00	---	---	---
15 Heat Trap Insert (Outlet)	415-45167-00	415-45167-00	---	---	---
16 Heat Trap Kit (Inlet & Outlet)	265-51572-00	265-51572-00	---	---	---

* Nipple extender 229-19100-00 may be required for earlier models, please provide serial number

Anode may need to be cut to length



United States

Sales 1-800-523-2931
Technical Support 1-800-334-3393
Email techsupport@bradfordwhite.com
Warranty 1-800-531-2111
Email warranty@bradfordwhite.com
Service Parts 1-800-538-2020
Email parts@bradfordwhite.com

Canada

Sales 1-866-690-0961 1-905-203-0600
Fax 905-636-0666
Warranty 1-800-531-2111
Email warranty@bradfordwhite.com
Technical Support 1-800-334-3393
Email techsupport@bradfordwhite.com
Service Parts and Orders ca.orders@bradfordwhite.com

For U.S. and Canada field service, contact your professional installer or local Bradford White sales representative.

International

General Contact international@bradfordwhite.com