



## Infiniti® GR Series Tankless (Condensing) Gas Water Heater



# START-UP GUIDE

### Start-up Guide and Instructions for Installation

(To be performed ONLY by  
qualified service providers)

### Models Covered by This Manual:

**Natural**

RTG-R-199-N1

**Propane**

RTG-R-199-X1

**TRAINING AND SERVICE INFORMATION**  
This document is restricted to exclusive use  
by the official service partners.

This document is not a substitute for the  
Installation Manual.



As required by the state of California Proposition 65.

# Recirc Model Display

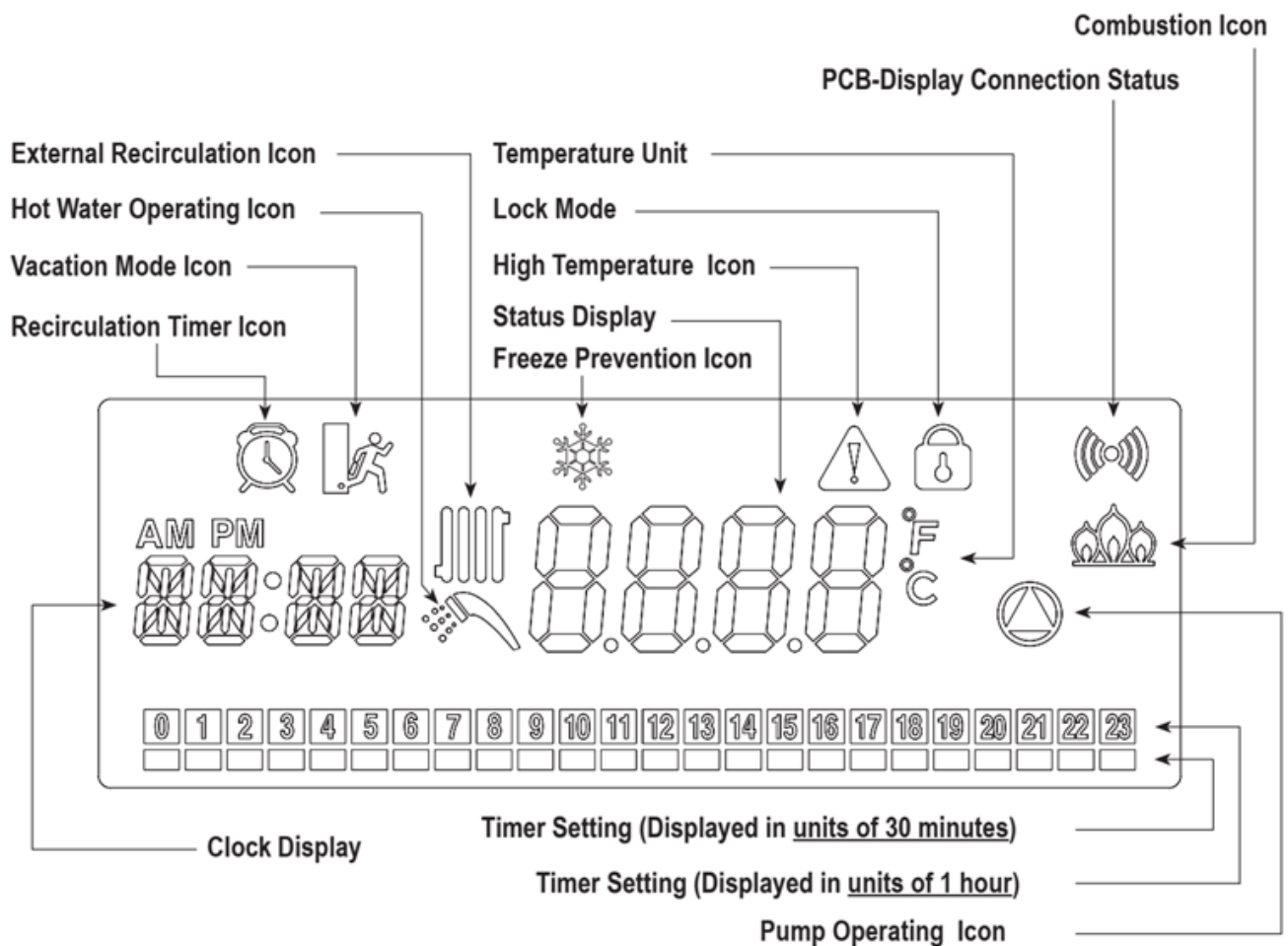
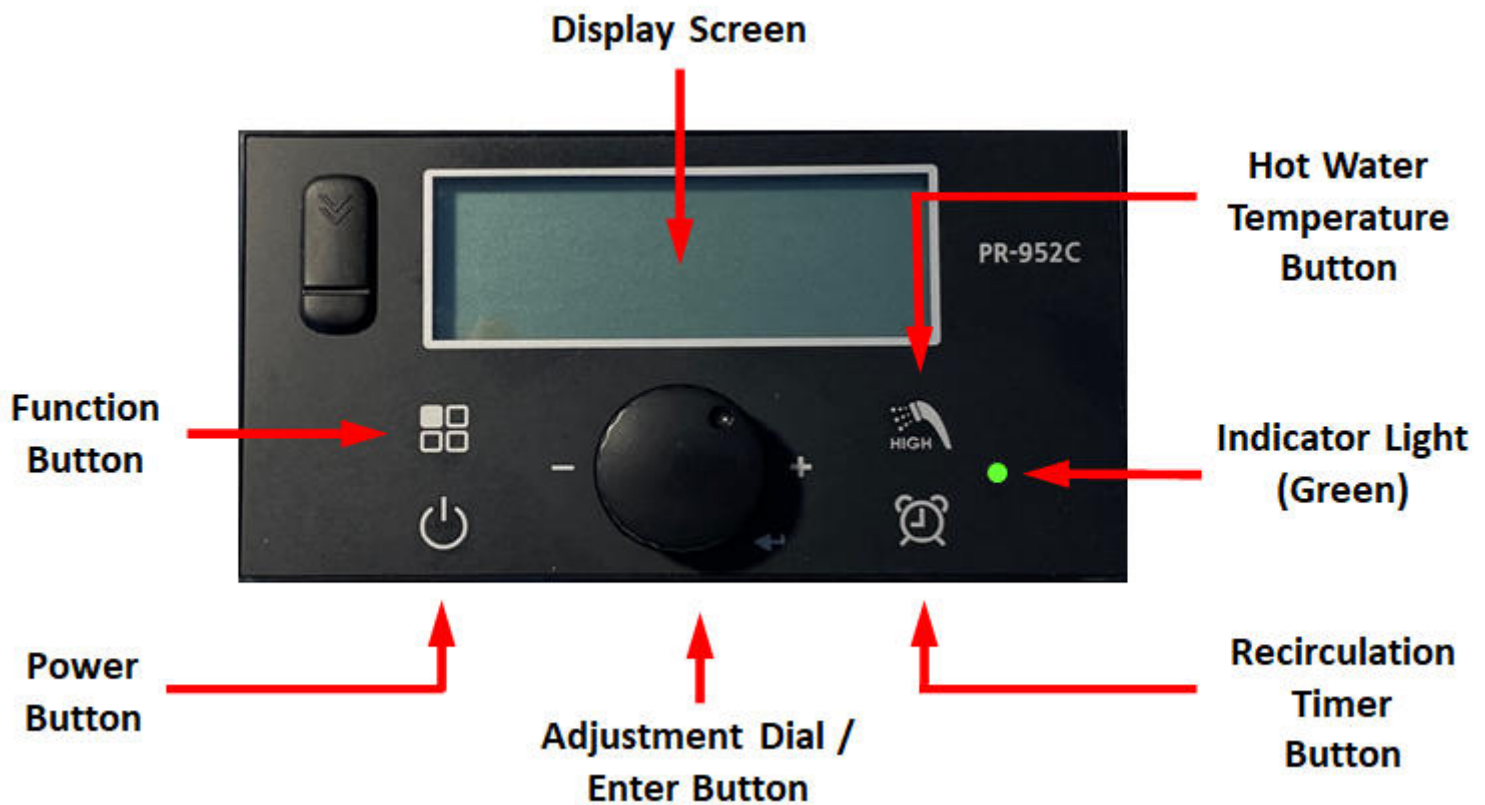

# Status Display Mode

## How to enter Status Mode:

With the Display powered On,

Press and Hold the Function Button 

- Use this mode for Diagnostic Troubleshooting
- Setting the Time
- Model Identification
- Gas Type
- Control/Display Firmware

Index		Description
Main	Sub	
A:GA	HotF	DHW flow rate value by On demand
	rCLF	Circulated water flow rate value by Internal pump
	b:Fr	Current Blower rpm
	C:oP	Heat Exchanger temperature
	D:dH	DHW Hot outlet temperature
	E:Eh	Exhaust gas temperature
	F:In	Cold Inlet temperature
G:rt	PH	Power Supply Time : 0000 hours
	rh	Burner Operating Time : 0000 hours
	It	Ignition attempts : 0000 cycles
	CF	Water accumulated : 0000 gallons
	PO	Pump ON time : 0000 hours
H:VP	AG	AGM Position (0 : Fully opened, 100 : Fully closed)
	FLCL	Incoming water control valve position(0 : Fully opened, 100 : Fully closed)
	bYPS	Mixing valve position(0 : Fully opened, 100 : Fully closed)
I:FC	GAL(Default)	Flow rate : gpm (Gallon / min), Temperature : F (Fahrenheit)
	Lit	Flow rate : lpm (Liter / min), Temperature : C (Celsius)
J:TA	HOURL	Hour setting : 0~23
	MIN	Minutes setting " 0~59
	K:MD	Model Identification (199 : 199,000 BTU)
	L:GT	Gas Type (ng, LP)
M:Pr	Pcb	Control board revision number
	PnL	Display Panel revision number
N:VA	oFF	Disable to Vacation Mode
	on	Enable to Vacation Mode

# Installer Mode

## How to enter Installer Mode:

With the Display powered OFF,

Press and Hold the Function Button 

- Check Error History
- Reset to Factory default settings
- Make Altitude Adjustment
- Select DHW Recirc Type
- Set Cascade address
- Re-initialize AGM, Water Valve and Mixing Valve

Index		Description
Main	Sub	
1:EH	E0:xx ~ E9:xx	E0:xx - Latest error, E9:xx - Oldest Error
2:cE	no(Default)	No clear Error history
	yES	Clear all error history
3:In	no(Default)	No reset
	yES	Reset Factory default except 4: AG, 5: FH and 6: FL
4:AG	Default : 0	Adjust AGM plate location for min only (-50 ~ +50)
5:FH	Default : 0	Adjust Blower pwm for High fire (-50 ~ +50)
6:FL	Default : 0	Adjust Blower pwm for Low fire (-50 ~ +50)
7:AH	Eco	Enable to Air Handler
	Ant	Anti-Bacterial Mode oFF - Standby Time / on - Operation Time
8:HA	0 - 2(Default)	0 ~ 2,000 ft (Sea Level)
	2 - 5	2,000 ~ 5,000 ft
	5 - 8	5,000 ~ 8,000 ft
	8 - 10	8,000 ~ 10,000 ft
9:RC	oFF(Default)	Deactivate Recirculation functions
	Itnl	Internal circulation mode
	Etnl	External circulation mode
	tt24	Title24 circulation mode
10:RT	CrOS	Crossover circulation mode
	HI-2	Recirculation temperature : High
	HI-1(Default)	Recirculation temperature : Medium
	Lo	Recirculation temperature : Low

Index		Description
Main	Sub	
11:IV	rIG (Default : 10)	Pump ON time set (1 ~ 60 minutes)
	POF (Default : 7)	Pump OFF time set (1 ~ 30 minutes)
12:HT	HI-2	Burner ON by Hot Outlet temp. : High
	HI-1(Default)	Burner ON by Hot Outlet temp. : Medium
	Lo	Burner ON by Hot Outlet temp. : Low
13:cn	Default :0	Cascade ID (0 : Not Cascaded, 1 : Leader, 2 : Follower)
14:Eh	oFF(Default)	Blowers in the cascade system operate independently (NRV installation required)
	on	Blowers operate simultaneously
15:Vt	PVC	PVC venting
	CPVC	CPVC / PP / SS venting
16:AL	oFF	Disabling Flushing Alarm
	365	Flushing alarm after 365 hours of hot water use
	700	Flushing alarm after 700 hours of hot water use
	1000	Flushing alarm after 1000 hours of hot water use
17:CK	A.PP1	Burner ON trial with Internal circulation
	b.PP2	Pump trial with External circulation
	c:FAn	Fan rotation trail (0 : stop, 100 : Max rpm)
	d.AG	AGM Initialization
	E.FL	Flow Control Valve Initialization
	F.bY	Mixing valve Initialization



# Setting Temperature (95 to 120 °F)

1. Press and release the Hot Water Temperature button



2. The shower symbol will appear and will blink on the screen



3. Turn the Adjustment Dial and select temperature (95 and 120°F)



4. Press the Adjustment Dial to set selected temperature



## Setting Temperature (125 to 140 °F)

1. Press and release the Hot Water Temperature button



2. The shower symbol will appear and will blink on the screen



3. Press + Hold the Hot Water Temperature button until 125° F and triangle with exclamation mark appears



4. Select temperature between 125 to 140°F and press Adjustment Dial to confirm



## Program DHW Recirculation:

To enter Installer Mode ① power down display then ② push and hold the function button

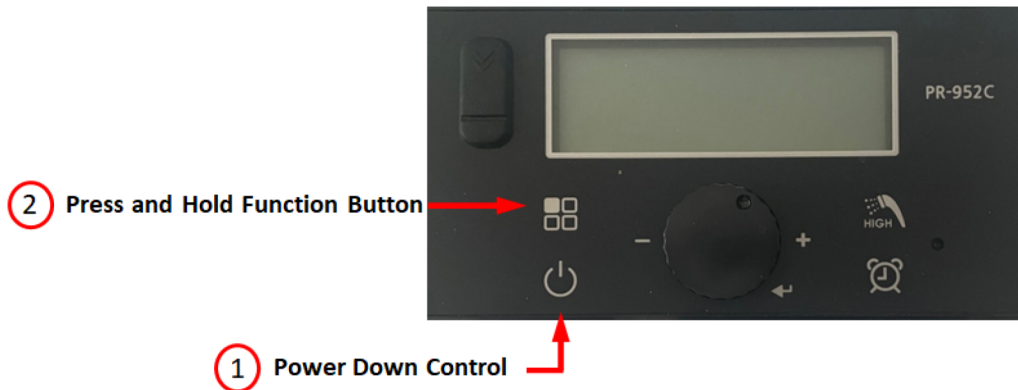

Rotate dial to Parameter 8: RC (DHW Recirculation). Push the center dial and select the type of Recirculation that will be used by rotating the dial. Select the type of Recirc by pushing the center dial



- ITNL – Internal Recirculation (Unit maintains internal temperature)
- ETNL – Unit will recirculate thru a dedicated system return loop
- TT24 – The system uses a third-party (field supplied) on-demand system
- CrOS – Retrofit Recirc system using under sink by-pass/crossover valve

Mode	Screen Display	Description	Setting	Requirement		Performance		
			11:RC	Dedicated Return Line	Accessory	Wait Time Water Savings	Energy Savings	Hot Water Temperature
Internal	ITNL	Hot water without dedicated return line.	Itnl	No	-	Better	Better	Better
External	ETNL	Quick hot water with dedicated return line.	Etnl	Yes	-	Best	Better	Best
On Demand (Title-24)*	tt24	Only operates recirculation line with a push of a button.	tt24	Yes	O	Better	Best	Best
Crossover	CrOS	Quick warm water without dedicated return line.	CrOS	No	O	Best	Good	Warm

## Program DHW Recirculation:

To enter Installer Mode ① power down display then  
② push and hold the function button

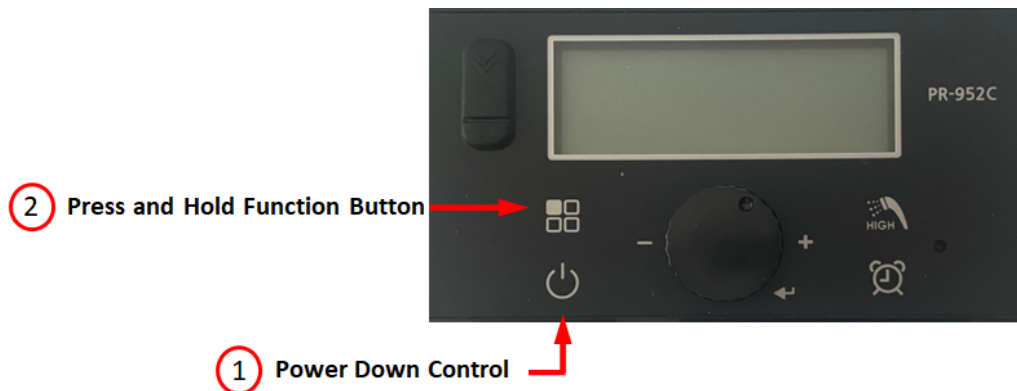

Rotate dial to Parameter 11: RC (DHW Recirculation). Push the center dial and select the type of Recirculation that will be used by rotating the dial. Select the type of Recirc by pushing the center dial



- ITNL – Internal Recirculation (Unit maintains internal temperature)
- ETNL – Unit will recirculate thru a dedicated system return loop
- TT24 – The system uses a third-party (field supplied) on-demand system
- CrOS – Retrofit Recirc system using under sink by-pass/crossover valve

Mode	Screen Display	Description	Setting	Requirement		Performance		
			11:RC	Dedicated Return Line	Accessory	Wait Time Water Savings	Energy Savings	Hot Water Temperature
Internal	ITNL	Hot water without dedicated return line.	Itnl	No	-	Better	Better	Better
External	ETNL	Quick hot water with dedicated return line.	Etnl	Yes	-	Best	Better	Best
On Demand (Title-24)*	tt24	Only operates recirculation line with a push of a button.	tt24	Yes	O	Better	Best	Best
Crossover	CrOS	Quick warm water without dedicated return line.	CrOS	No	O	Best	Good	Warm



After selecting DHW Recirc Type – push the Function Button  to exit the Installer Mode then power up The display.

Set current Time by entering Status Display Mode

- With the Display powered On,  
Press and Hold the Function Button



- Turn center dial to J:TA



- Push the center dial and program Hour and Minutes (note: it is a 24HR Clock)
- After setting the Time, push the function button  to exit the display status mode



For Internal, External and Crossover Recirc select the time periods throughout the day when the recirc should be active. The Default program will be active from 5 a.m. to 8 a.m and 5 p.m. to 10 p.m.



← The # represents the first 30 minutes of an hour

← The dash below the # is the final 30 minutes of an hour



Push the Clock Button  
to program Recirc



Turn the dial and select SET



Use the blinking cursor and  
center dial (turn +press) to  
select the desired active  
program times

Push and Hold center dial  
to save

Push the Clock button once  
to exit



For U.S. and Canada field service,  
contact your professional installer or  
local Bradford White sales representative.

**Sales/800-523-2931**  
***Fax/215-641-1670***  
***Parts Fax/215-641-2180***

**Technical Support/800-334-3393**  
***Fax/269-795-1089***

**Warranty/800-531-2111**  
***Fax/269-795-1089***

**International:**  
**Telephone/215-641-9400**  
***Telefax/215-641-9750***



**Sales & Technical Support/866-690-0961**  
**905-203-0600**  
***Fax/905-636-0666***

**Email**  
**parts@bradfordwhite.com**  
**techserv@bradfordwhite.com**

**www.bradfordwhite.com**